



Hennepin County **Memo**

Date: July 3, 2018
To: County Board of Commissioners
From: Shawn Wink, Hennepin County TIF Administrator
Subject: Bridgewater Bank TIF District – St Louis Park

Public Hearing: Monday, July 16, 2018 7:30 PM

Proposal:

The St Louis Park EDA and the City of St Louis Park are proposing the creation of a redevelopment tax increment financing district, with a maximum life of 26 years.

The site of the proposed TIF District consists of 3 parcels of land and adjacent right-of-ways, Northwest of Excelsior and Northeast of Monterey (see attached map).

Approximately \$5.6 million of increment is projected over the life of the district.

Increments collected will be used to facilitate the development of approximately 65,894 square feet of office space, approximately 7,530 square feet of first floor retail, as well as a parking structure.

If you would like more detail on the district please contact me via e-mail or telephone at:



shawn.wink@hennepin.us
348-5475

CC: David Hough, County Administrator
Mark Chapin, Director, Resident and Real Estate Services
Kevin Dockry, Public Works

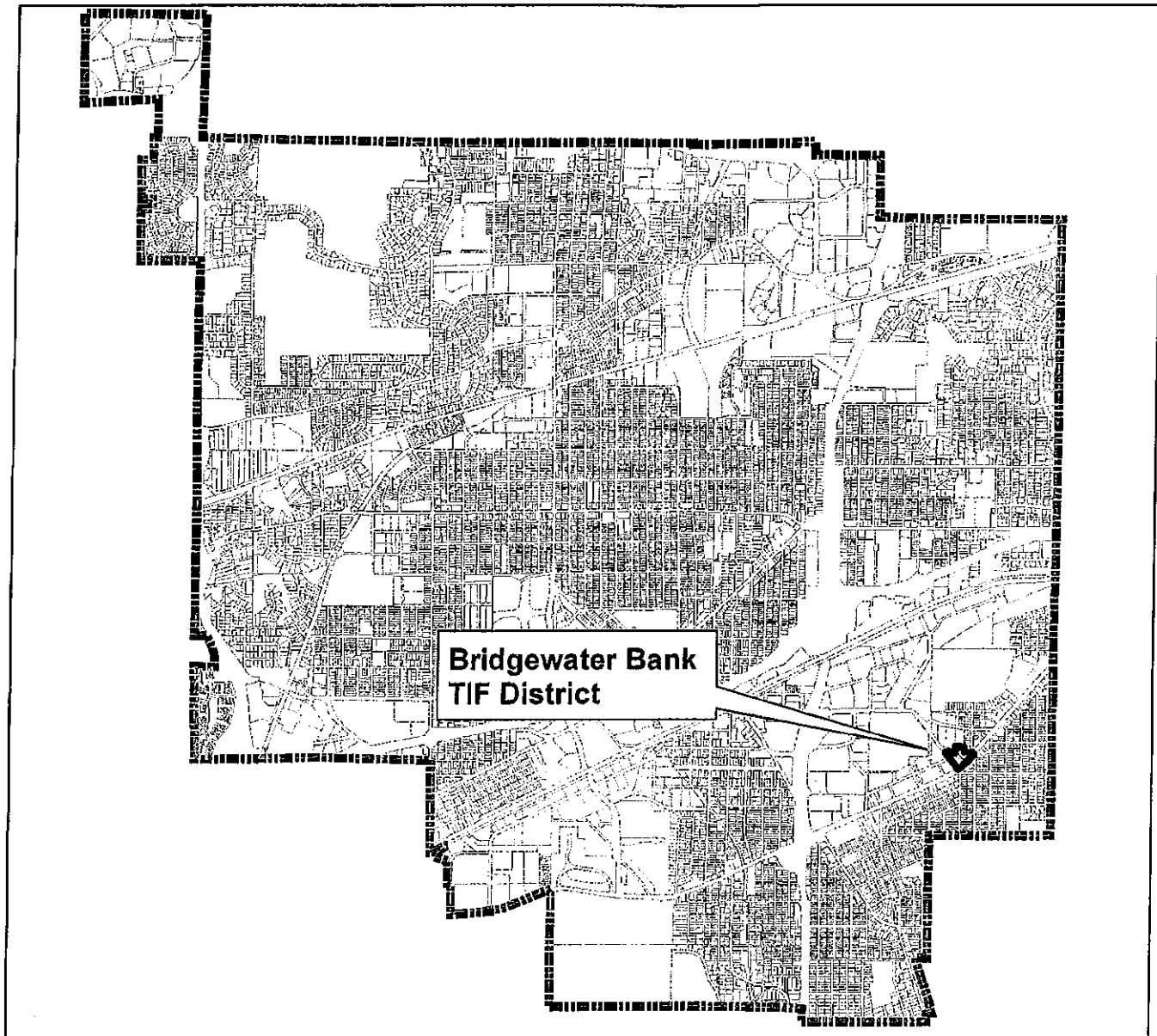
Bridgewater Bank Tax Increment Financing District



Legend

-  Bridgewater Bank TIF District
-  Redevelopment Project Area No 1
-  Parcels

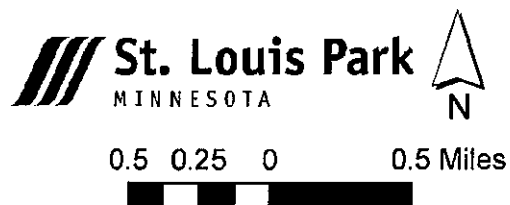

May 15, 2018

Prepared by the St. Louis Park Community Development Department

Bridgewater Bank Tax Increment Financing District

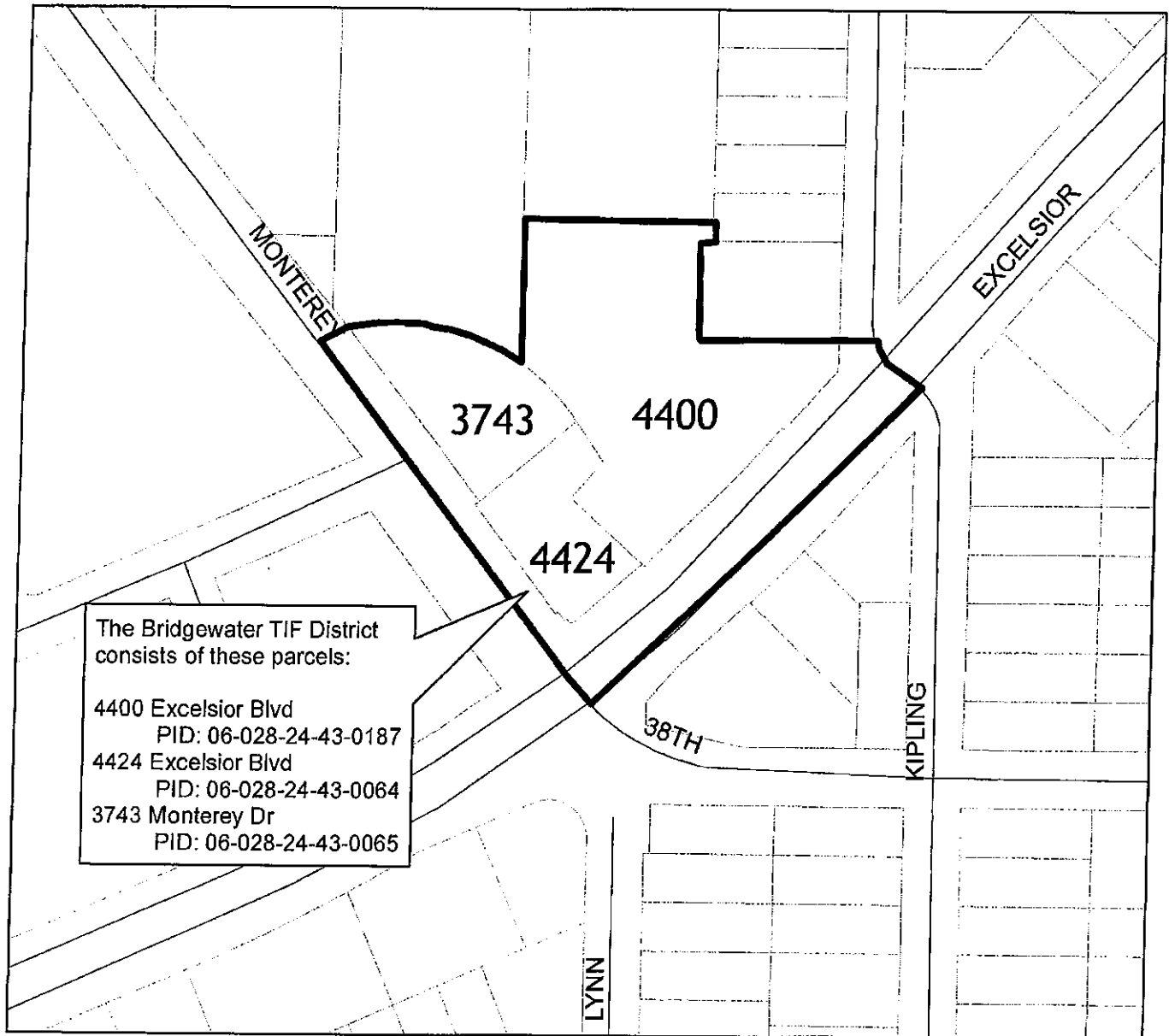

Legend

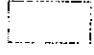
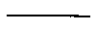
-  Bridgewater Bank TIF District
-  Parcels
-  Roads



St. Louis Park
MINNESOTA



150 75 0 150 Feet



May 15, 2018

Prepared by the St. Louis Park Community Development Department